



# Air-operated pumps for DISTRIBUTION

Ratio 3:1 Flow rate 20 l/min



**Air-operated pumps series 500 and 600 for medium distance distribution.** Ideal for transferring low-medium viscosity fluids such as: oils, lubricants and similar products. Suitable for mobile unit or fixed installation. The wall-mounted version of these pumps, mounted on wall or in a fixed position by means of the special accessories (refer to page 107), enables numerous uses through the application of modular extensions (refer to page 112).

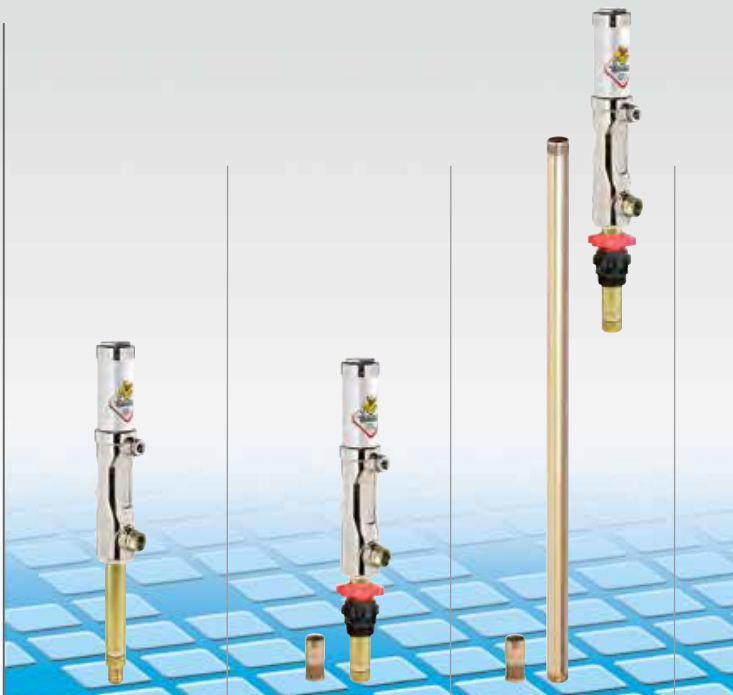

series 500

Article with seals in	NBR		
Article with seals in	NBR		
Article with seals in	Viton®	35060	35061
Compatible fluids		Oils, lubricants and similar	
Suction tube upper body		Aluminum	
Suction tube		Carbon steel	
Air inlet connection	bsp	F 1/4" G	F 1/4" G
Fluid outlet connection	bsp	F 1/2" G	F 1/2" G
Air working pressure	bar	6 - 8	6 - 8
Average air consumption	l/min	350	350
Noise level	dB	81	81
Max deliverable oil viscosity	SAE	130	130
Bung adaptor		-	standard
		standard	standard
Suitable for drums or tank		modular	customisable 1"
		tank	
Packing	N° - m <sup>3</sup>	1 - 0,01	1 - 0,01
Weight	kg	5,35	5,8
Dimensions (A - B - C)	cm	33,2 - 20 - 3,2	33,2 - 18,5 - 3,2

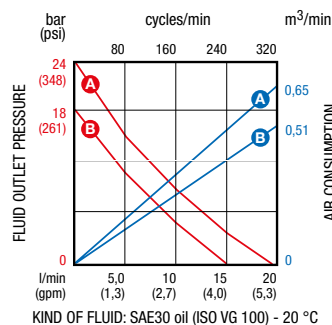
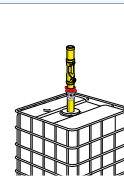
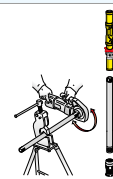
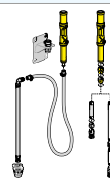

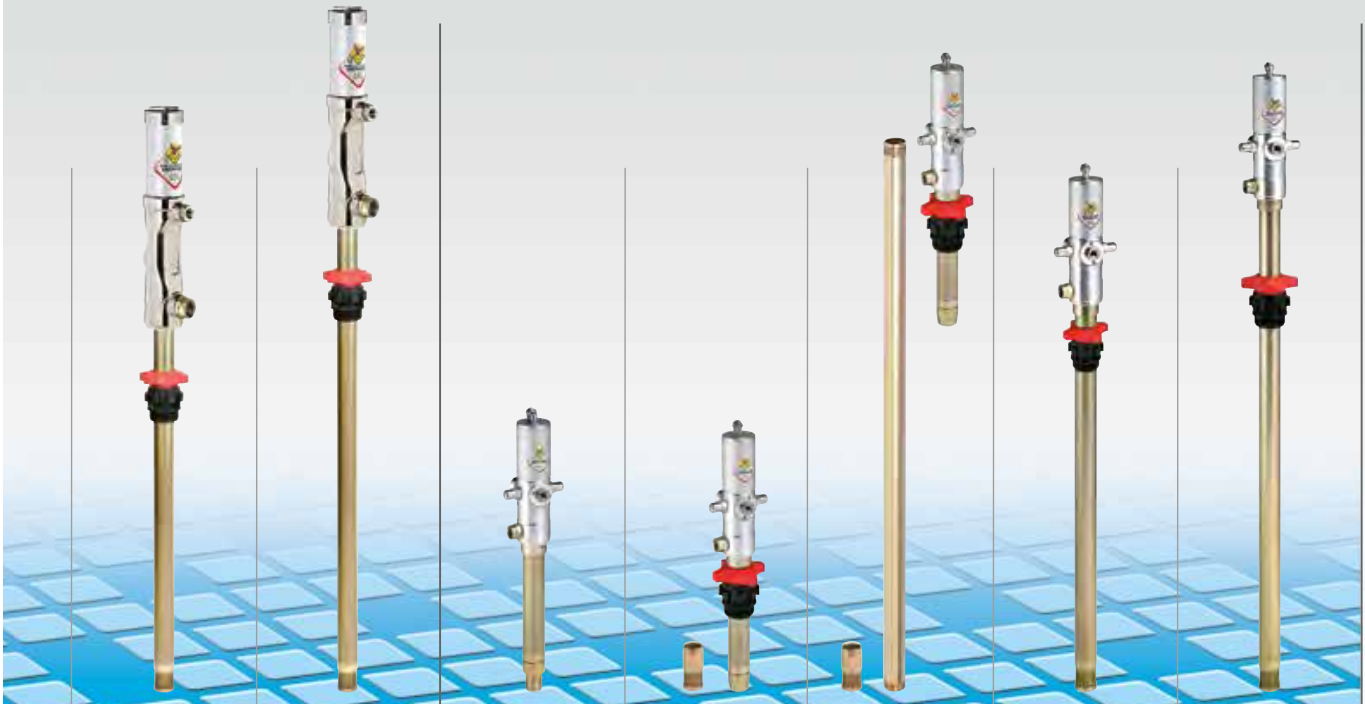

series 500		series 600				
		<b>35160</b>	<b>35161</b>	<b>35163</b>	<b>35173</b>	<b>35194</b>
					<b>35176</b>	<b>35196</b>
<b>35076</b>	<b>35094</b>					
Oils, lubricants and similar Aluminum Carbon steel		Oils, lubricants and similar Aluminum Carbon steel				
F 1/4" G	F 1/4" G	F 1/4" G	F 1/4" G	F 1/4" G	F 1/4" G	F 1/4" G
F 1/2" G	F 1/2" G	F 1/2" G	F 1/2" G	F 1/2" G	F 1/2" G	F 1/2" G
6 - 8	6 - 8	6 - 8	6 - 8	6 - 8	6 - 8	6 - 8
350	350	330	330	330	330	330
81	81	81	81	81	81	81
130	130	130	130	130	130	130
standard	standard	-	standard	standard	standard on 35176	standard on 35196
suitable for drums 50-60 kg	suitable for drums 180-220 kg	modular	customisable 1"	tank	suitable for drums 50-60 kg	suitable for drums 180-220 kg
1 - 0,01	1 - 0,01	1 - 0,01	1 - 0,01	1 - 0,02	1 - 0,020	1 - 0,020
5,8	6,5	4,4	5,0	6,8	5,8	6,5
33,2 - 74 - 3,2	33,2 - 94 - 3,2	28,5 - 28,5 - 4,2	28,5 - 22 - 4,2	28,5 - 125 - 4,2	28,5 - 74 - 4,2	28,5 - 94 - 4,2

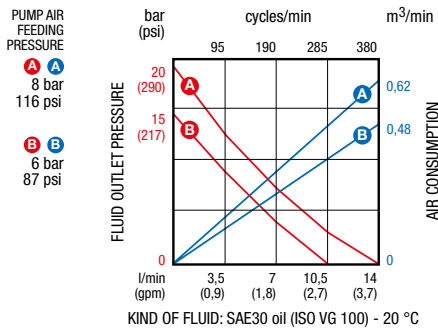
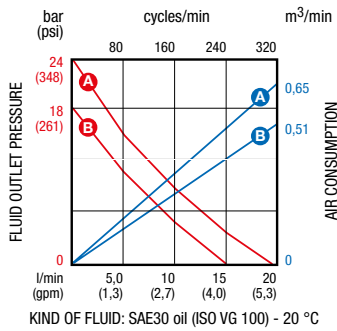

## P/N 35163

Pneumatic piston pump s. 600 for distributing oil and similar, R 3:1 - 14 l/min with NBR seals and suction tube 1250 mm with bung adaptor for tanks

### AREAS OF USE

Aeronautics, Automotive, Building and road construction, Manufacturing industry, Lube trucks and transports, Railway transport

### FEATURES

Flow rate	14 l/min
Ratio	3:1
Compatible fluids	oils, lubricants and similar
Suction tube upper body	aluminum
Suction tube	carbon steel
Air inlet connection	G 1/4" (f)
Fluid outlet connection	G 1/2" (f)
Air working pressure	6 ÷ 8 bar
Average air consumption	330 l/min
Noise level	81 dB
max deliverable oil viscosity	SAE 130
Bung adaptor	standard
Suitable for drums or tanks	tank
Packing	No. 1 - 0,02 m3
Weight	6,8 kg



### OVERALL DIMENSIONS (mm)

