

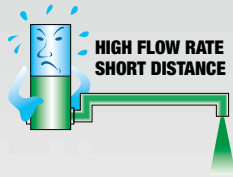

Air-operated pumps for TRANSFER

Ratio 1:1 Flow rate 35 l/min



Air-operated pumps for short and medium-distance transfer.

Ideal for transferring low-medium viscosity fluids such as: oils, lubricants and similar products. The wall-mounted version of these pumps, mounted on wall or in a fixed position by means of the special accessories (refer to page 107), enables numerous uses through the application of modular extensions (refer to page 112).

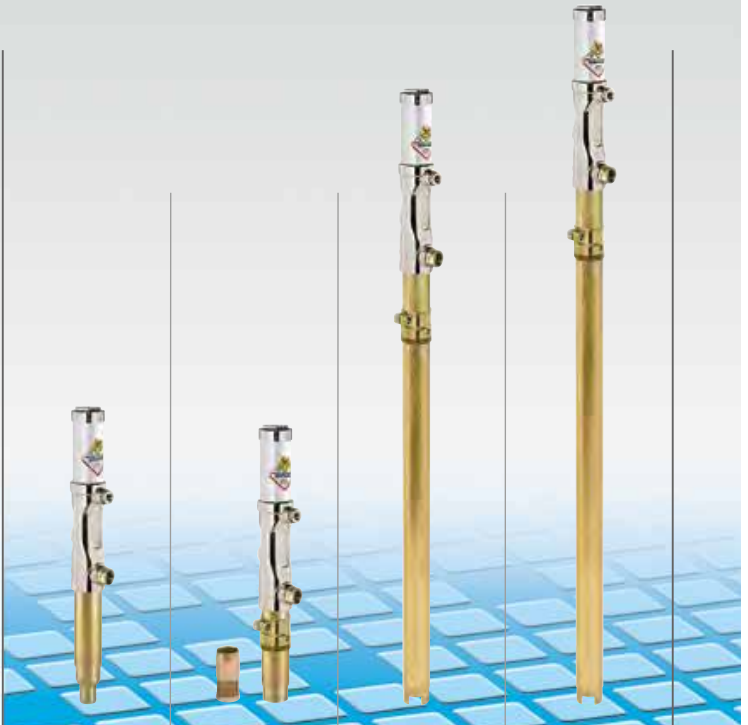

series 500

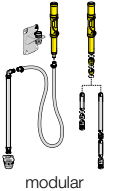
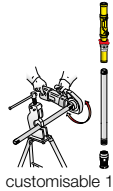
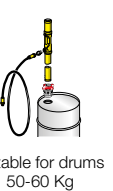
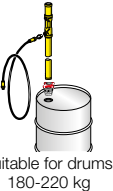
Article with seals in	NBR				
Article with seals in	Viton®	26090	26091	26093	26094
Article with seals in	Teflon®				
Compatible fluids		Oils, lubricants and similar			
Suction tube upper body		Aluminum			
Suction tube		Carbon steel			
Air inlet connection	bsp	F 1/4" G	F 1/4" G	F 1/4" G	F 1/4" G
Fluid outlet connection	bsp	F 3/4" G	F 3/4" G	F 3/4" G	F 3/4" G
Air working pressure	bar	6 - 8	6 - 8	6 - 8	6 - 8
Average air consumption	l/min	250	250	250	250
Noise level	dB	81	81	81	81
Max deliverable oil viscosity	SAE	80	80	80	80
Bung adaptor		-	standard	standard	standard
Suitable for drums or tanks		 modular	 customisable 1"	 suitable for drums 50-60 Kg	 suitable for drums 180-220 kg
Packing	N° - m ³	1 - 0,010	1 - 0,010	1 - 0,020	1 - 0,020
Weight	kg	5,5	6	7,2	7,2
Dimensions (A - B - C)	cm	33,2 - 20,8 - 5	33,2 - 16,8 - 5	33,2 - 74 - 5	33,2 - 94 - 5

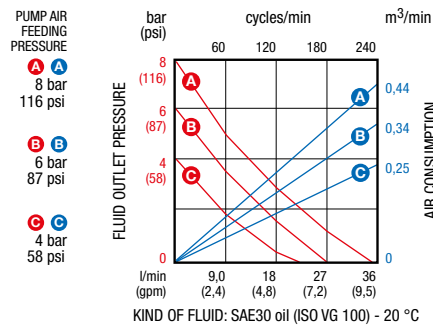
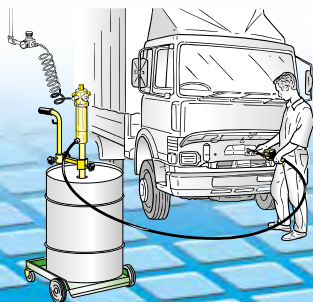

Ratio 1:1 Flow rate 23 l/min

Ratio 1:1 Flow rate 40 l/min

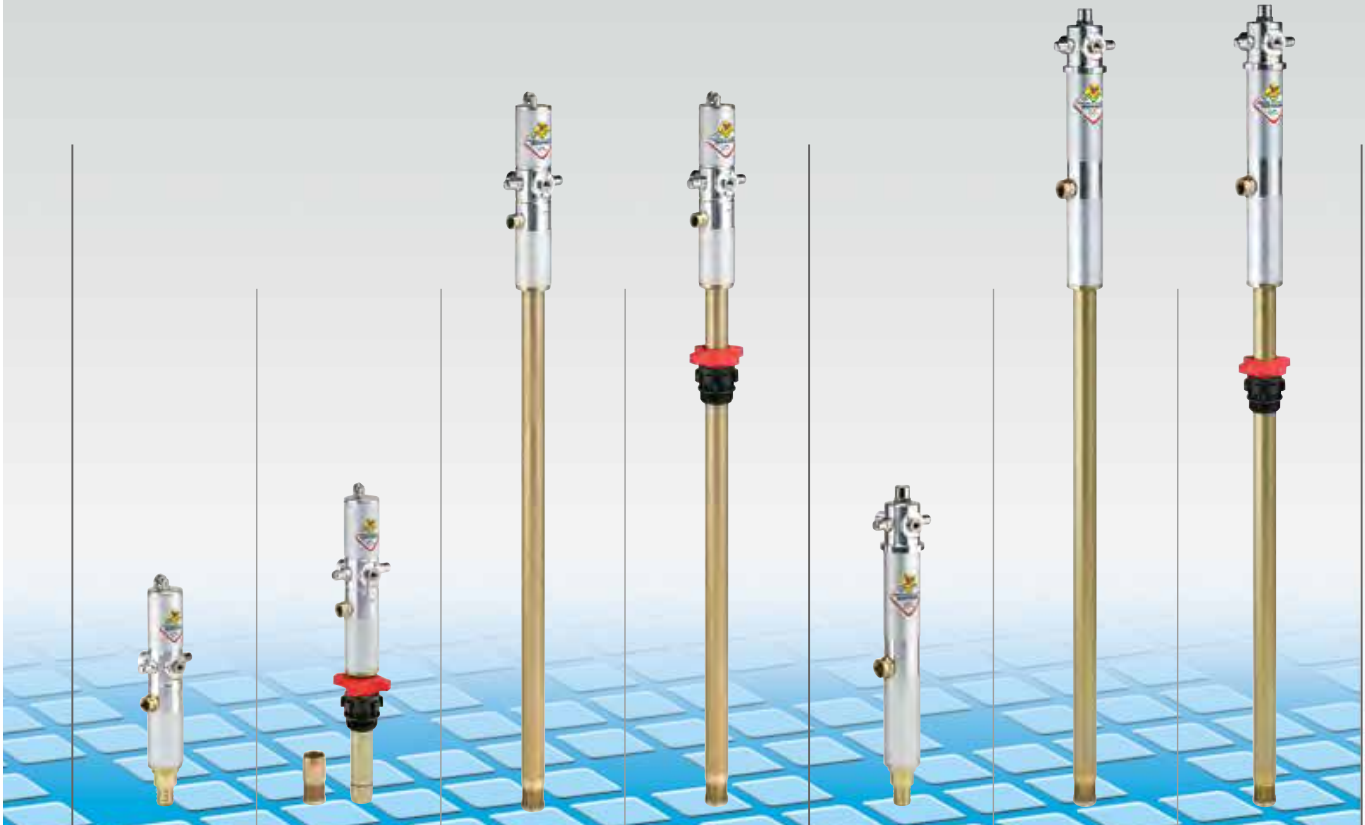

series 600

serie 650

33080	33081	33082	33083			
33070	33071	33072	33073	33170	33172	33173
33060	33061	33094	33096	33160	33194	33196

Oils, lubricants and similar

Oils, lubricants and similar

Aluminum
Carbon steel

Aluminum
Carbon steel

F 1/4" G	F 1/4" G	F 1/4" G	F 1/4" G	F 1/4" G	F 1/4" G	F 1/4" G
F 1/2" G	F 1/2" G	F 1/2" G	F 1/2" G	F 3/4" G	F 3/4" G	F 3/4" G
6 - 8	6 - 8	6 - 8	6 - 8	6 - 8	6 - 8	6 - 8
230	230	230	230	370	370	370
81	81	81	81	81	81	81
80	80	80	80	130	130	130

standard

standard

standard

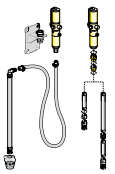

modular

1 - 0,006
4,3

35,5 - 0 - 0

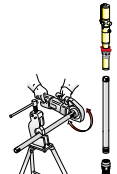

customisable 1"

1 - 0,006
5

35,5 - 22 - 4,2



suitable for drums
180-220 kg

1 - 0,020
6,2

35,5 - 94 - 4,2



suitable for drums
180-220 kg

1 - 0,020
6,3

35,5 - 94 - 4,2

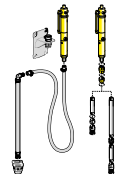

modular

1 - 0,010
5,3

50,5 - 0 - 0



suitable for drums
180-220 kg

1 - 0,020
7,3

50,5 - 94 - 4,2

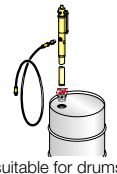

suitable for drums
180-220 kg

1 - 0,020
7,4

50,5 - 94 - 4,2

PUMP AIR FEEDING PRESSURE
A A 8 bar 116 psi
B B 6 bar 87 psi
C C 4 bar 58 psi

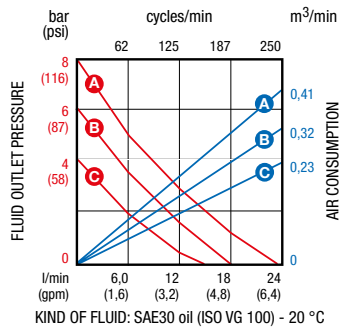

PUMP AIR FEEDING PRESSURE
A A 8 bar 116 psi
B B 6 bar 87 psi
C C 4 bar 58 psi

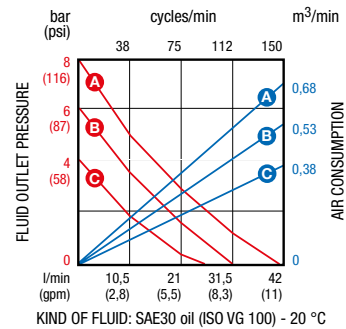

P/N 33170

Modular pneumatic piston pump s. 650 for transferring oil and similar, R 1:1 - 40 l/min with Viton® seals

AREAS OF USE

Aeronautics, Automotive, Building and road construction, Manufacturing industry, Lube trucks and transports, Railway transport

FEATURES

Flow rate	40 l/min
Ratio	1:1
Compatible fluids	oils, lubricants and similar
Suction tube upper body	aluminum
Suction tube	carbon steel
Air inlet connection	G 1/4" (f)
Fluid outlet connection	G 3/4" (f)
Air working pressure	6 ÷ 8 bar
Average air consumption	370 l/min
Noise level	81 dB
max deliverable oil viscosity	SAE 130
Bung adaptor	-
Suitable for drums or tanks	modular
Packing	No. 1 - 0,010 m3
Weight	5,3 kg



OVERALL DIMENSIONS (mm)

